

Scale 1:1

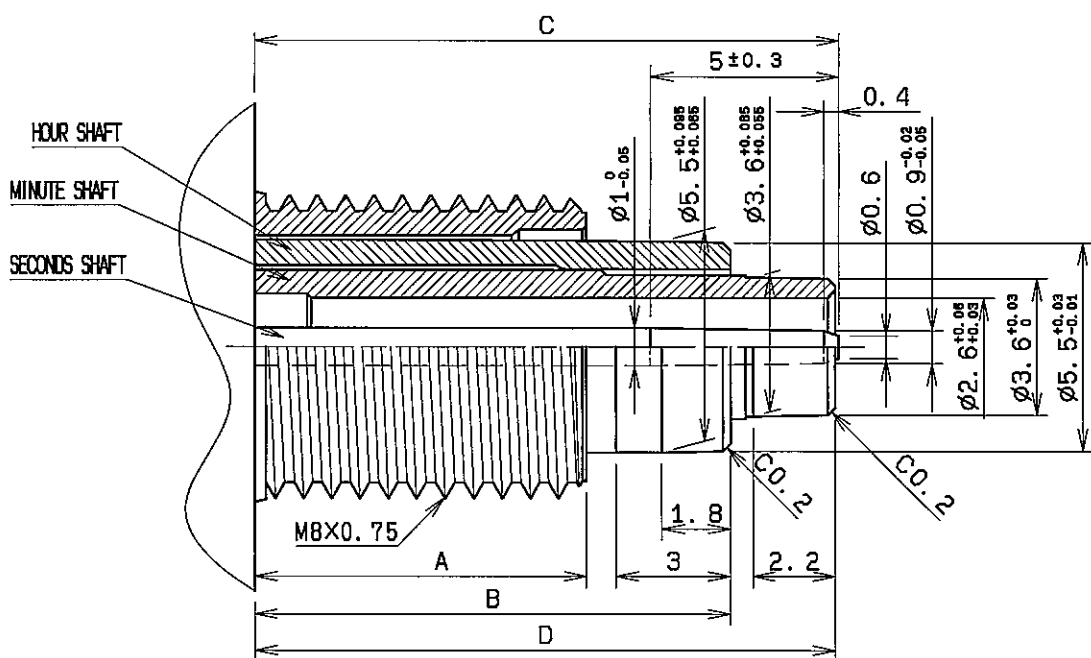

Detail A(5:1)

Circuit form :C-MOS IC 1pcs.
Original governor :Crystal oscillator 4.194304 MHz
Indication :3 hands step motion
Starting method :Automatic start
Time adjustment function :Reverse side turns
Melody :Westminster,Whittington
Accuracy :Monthly rate ±20 seconds
Usage temperature range :(-10~+50)°C
Usage voltage range :(1.3~1.7)V
Output torque :Minute hand More than 2.7x10⁻⁴Nm(27gfcm)/1.3V
Second hand More than 5x10⁻⁴Nm(5gfcm)/1.3V
Power source :Alkaline(LR14)x1pcs, 1.5V
Battery life :About 1 year
Accuracy of striking :With in ±30sec
Striking sound pressure :According to speaker specifications
Striking current :According to speaker specifications

Condition of casing			
• Fitting method:Center Screw or Screw M3x2pcs • The torque to fasten is less than 1N·m(10kgfcm) • Pressure for hands press fitting : Less than 50N(5kgf) • Metal hands is as follows. * If you use plastic hands, please make dimensions smaller than below.			
Hour Hand		a 5.5 ^{+0.02} b 6.2 c 2.5	
Minute Hand		a 3.6 ^{+0.02} b 4.3 c 2.7	
Seconds Hand		a 7.2±0.1 b 3.6±0.2 c 0.9 ^{+0.02} d 1.6 ^{+0.08}	
Scale 1:1			
Condition	Unbalance N·m (gf·cm)	Weight (g)	Length from center (mm)
Hands			
Seconds hand	Less than 1.5x10 ⁻⁴ (0.15)	Less than 2	Less than 130
Minute Hand	Less than 3x10 ⁻⁴ (3)	Less than 5	Less than 160
Hour hand	Less than 1x10 ⁻⁴ (3)	Less than 5	Less than 160

Made in SEIKO Factory (Thailand)

CAL.	A:Center Screw	B:Hour Hand	C:Seconds Hand	D:Minute Hand
16301V	8.8	12.6	15.5	15.4

No.	NAME	X	Y
8	Guide hole	29.4	-30.7
7	Guide hole	-17.2	15
2	Fixing hole	-15.1	-31.5
1	Fixing hole	29.3	21
0	Hand center	0	0